

McCoy

A Promise of Happiness

USE & CARE MANUAL
CUM WARRANTY CARD

WASHING MACHINE
SEMI AUTOMATIC

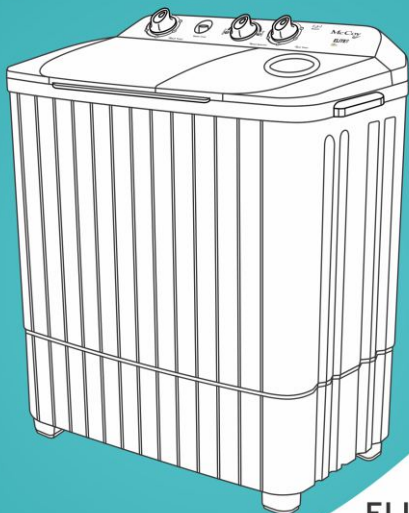

ELITE 6.5

6.5kg

ELITE

6.5kg

Please read the instruction manual carefully before use and request to keep it safe and handy.

Dear Customer,

Congratulations and now you are the proud owner of McCoy Washing Machine.

McCoy Washing Machine is innovatively designed with advanced technology.

Your Washing Machine is manufactured at India's manufacturing setup under stringent quality norms to give you a world class product with years of trouble free operation.

Please read the instruction manual carefully before using the product and keep it carefully for future reference.

We promise you Happiness with McCoy.

Best Wishes

Please register your product on our mobile app.

Contents

Parts Identification	1
Specifications	2
How To Install	3
How To Wash	4
How To Intermediate Spinning	5
How To Rinse.....	5
How To Spin.....	6
How To Measure Wash Load & Washing Guide	7
Caution.....	8
How To Maintain	9
Warranty.....	10-11

PARTS IDENTIFICATION

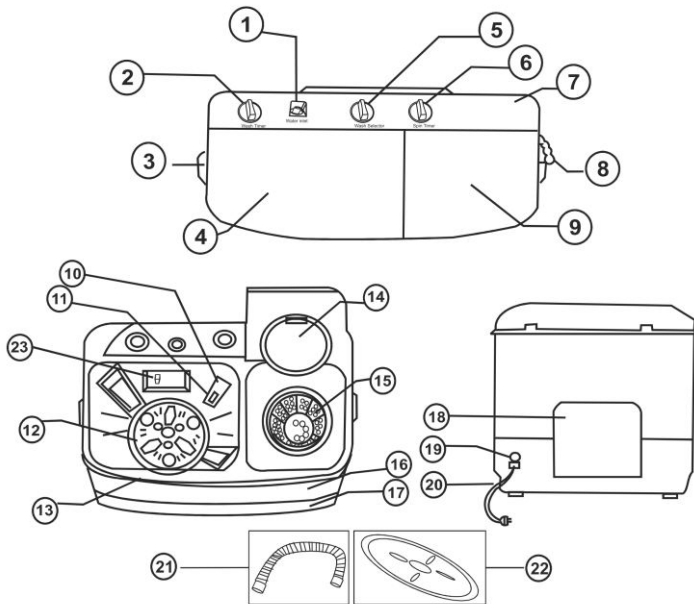

- | | | |
|------------------------------------|------------------------|--------------------------|
| 1. Water Inlet | 8. Drain Hose | 16. Outer Shell |
| 2. Wash Timer | 9. Spin-Dry Lid | 17. Machine Stand |
| 3. Hanging Hook | 10. Overflow Filter | 18. Back Cover |
| 4. Wash Lid | 11. Filter Box | 19. Ground Wire |
| 5. Selector Switch
(Wash/Drain) | 12. Pulsator | 20. Cable And Plug |
| 6. Spin Timer | 13. Cabinet | 21. Water Inlet Hose |
| 7. Control Panel | 14. Spin-Dry Inner Lid | 22. Safety Cover |
| | 15. Spin-Dry Basket | 23. Water Inlet Selector |

SPECIFICATIONS

Model	ELITE / ELITE PRO
Capacity	6.5 kg. (dry weight of clothes)
Type	Pulsator
Power Source	230 Volts AC, 50 Hz
Input Wattage	460W
Dimensions (in mm)	750(W) x 450(D) x 875 (H)
Net Weight (ELITE)	18 kg
Net Weight (ELITE PRO)	18.5 kg

Due to continuous development and modifications, features/specifications of the product may change without notice.

HOW TO INSTALL

Choosing the right location

Install your McCOY Washing Machine on an even, stable place. An unstable location:

- Can be dangerous since vibrations may cause your machine to move.
- Can create noise as your machine may vibrate.
- Keep a distance of at least 5 cm between the sides and rear of your machine and the nearest wall. This will reduce noise while operating the machine.
- Do not place your machine in an area with high humidity or direct exposure to sunlight or rain. This can cause deformation or discoloration of plastic parts.
- Keep your washing machine at a location free from high humidity and direct sunlight.

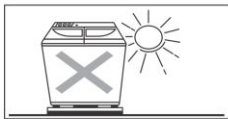
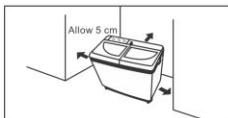
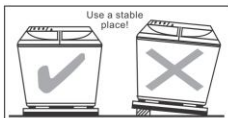

Step-by-step installation

- Lower the drainage hose to the floor. Make sure that the drainage hose is not kept too high, else it may not drain properly.
- Connect the water supply pipe to the water inlet.
- Plug in the power cord into the power supply socket. The machine requires a 230V, 50Hz 5Amp. AC electrical supply.
- Place your machine on a level ground, if the floor is uneven, place a board underneath and bring it to a level position.
- To check if your machine is on a level ground, use a weight attached to a string. The distance between the string and your machine should be the same from top to bottom.

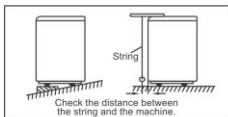
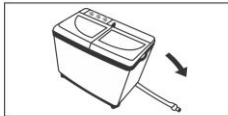

HOW TO WASH

Precautions before washing

- Strings of aprons, petticoats, pyjamas etc. should be tied as this will prevent clothes from getting entangled.
- Close fasteners/zippers of trousers and jeans as this will prevent scratching of the wash tub.
- Remove articles like match sticks, hair pins, coins etc. from pockets before washing.
- Add clothes one by one. Remove hooks, laces, pins and pull up all zips. If the hooks cannot be removed tie all of them up in one Garment. Failure to do so will damage the machine.

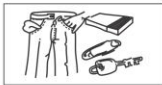

Control Panel

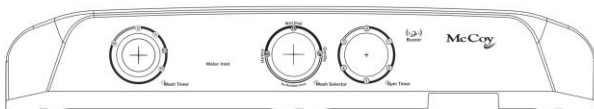

Washing

- Shift the wash selector knob to 'Heavy/Gentle' position and the water supply knob to 'Wash Tub' position.
- Set the water level depending on the wash load. (Please refer the table under 'How To Measure Wash Load & Washing Guide')
- Turn on the water supply and allow water to fill 2-3 cms lower than the water level selected. Add the detergent and mix properly so that the detergent dissolves fully in water.

Note: If water flows out of the water feed indicator outlet located in the Wash Tub it indicates that water is flowing at a high speed which could cause water to spill over into the Spin Tub. Reduce the water flow till water stops flowing out of the water feed indicator outlet.

- Now put the wash load into the Wash Tub and fill water upto the water level selected.
- Select the cycle required for washing depending on the quantity of clothes to be washed, the type of fabric and the dirt levels of the clothes. Choose between 'Heavy/Gentle' by turning the wash selector knob.
- Select the wash time required. The time will vary depending on the number of clothes and type of fabric. Clothes can be soaked prior to wash (especially for soiled clothes) by setting the wash timer anywhere between 15 min to 35 min position. Total time available for soak is 20 min max. Total wash time with soak is 35 min.
- Set the wash time by turning the Wash Timer clockwise. The machine start working immediately on turning the knob.
- After washing has stopped shift the Wash selector knob to 'Drain' position to drain out the water from the Wash Tub.

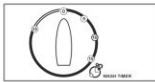
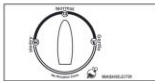

HOW TO INTERMEDIATE SPINNING

After the wash cycle, it is suggested that an Intermediate spin cycle with the Spin Shower facility be carried out. This helps remove the detergent solution from clothes and rinsing becomes more effective.

How to use the Spin Shower

- Remove washed clothes from the Wash Tub and transfer them uniformly into the Spin Tub as shown in Fig A.
- The Spin Cap needs to be placed horizontally above the clothes as shown in Fig A. Even in case of a small lot of clothes, the Spin Cap should be placed above the clothes. This is a safety requirement. The clothes and the Spin Cap should not be placed as shown in Fig B, as this could lead to vibrations and cause a rattling sound during the Spin Cycle.
- Shift the Water Supply Selector knob to 'Spin Tub' and allow the water to flow for about 1 minute.
- Turn off the water supply and close the Inner Spin Tub lid and the Spin Tub lid.

Note: Spinning will not start till the Spin Tub lid is shut. For safety reasons the machine is provided with a brake mechanism which gets activated as the spin tub lid is opened. This safeguards against accidental opening of the Spin Tub lid when the tub is in spinning at a high speed.

- Set the Spin timer by turning the knob clockwise. Choose between 1-5 minutes depending upon type and no. of clothes. For details refer to section

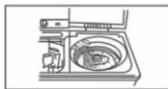

HOW TO RINSE

After the wash and Intermediate Spin cycle use the Rinse cycle. This helps remove detergent from the clothes and makes them soap-free. Rinsing can be done in the following way:

- Shift the Wash selector knob to 'Gentle/ Normal' position.
- Fill water upto the desired level.
- Set the wash timer to 2-3 minutes.
- After the rinsing cycle is over shift the Wash Selector knob to 'Drain' position. This will drain out the water from the Wash Tub.
- Transfer the clothes to the Spin Tub for intermediate spinning.
- Repeat this process two to three times for best results.

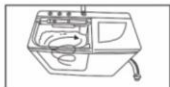
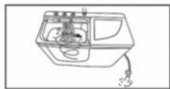

HOW TO SPIN

- Remove washed clothes from the Wash Tub and transfer clothes uniformly into the Spin Tub as shown in Fig A.
- The Spin Cap needs to be placed horizontally above the clothes as shown in Fig A. Even in case of a small lot of clothes, the Spin Cap should be placed above the clothes. This is a safety requirement.
- The clothes and the Spin Cap should not be placed as shown in Fig B. as this could lead to vibrations and cause a rattling sound during the Spin cycle.
- Shut the Inner Spin Tub lid and the Spin Tub lid.

Note: The Spinning will not start till the Spin Tub lid is shut. For safety reasons the machine is provided with a brake mechanism which gets activated as the Spin Tub lid is opened. This safeguards against accidental opening of the Spin Tub lid when the tub is spinning at a high speed.

- Set the Spin time by turning the Spin Timer clockwise. Refer to table on guidelines for setting Spin time.
- Once the set spin time is over the timer returns to its original position and the spinning activity stops.



Ending the process

- Switch off the main power supply and unplug the power cord.
- Drain the water completely from the drain pipe. Then hang the drainage hose on the hook provided on the side of the machine. Shift the water selector knob to 'Wash/Rinse' position.

Caution

- If bleaching powder or starch is used for washing rinse the Wash Tub and Spin Tub with water and drain. This is required to remove any left over bleach/starch which may otherwise damage the Wash/Spin Tub.
- Remove the water supply joint first and then remove the water supply hose as this prevents water from spilling on to the controls of the machine.

Type of Fabric	Spin Time
Synthetic clothes	1 minute
Woolens	1-2 minutes
Shirts / Trousers	2-3 minutes
Bedsheets / Towels	5 minutes

HOW TO MEASURE WASH LOAD & WASHING GUIDE

Here are some of the average weights of commonly used clothes, to help you estimate the weight of the load to be washed.

Approximate dry weight of clothes

Item of clothing	Weight (in gms.)	Item of clothing	Weight (in gms.)
Double bedsheet	1000	Single bedsheet	500
Bath towel	500	Table cloth	650
Trousers	400	Jeans	600
Shirt	300	Baggies	500
Saree	500	Petticoat	400
Pyjamas	400	Dhoti	200
Skirts	250	Nightgown	250
Lungi	225	Baniyan	50
Blouse	100	Undergarment	50

How to select wash cycle settings, wash time and water level.

Washing (Weight)#	Water Level	Cycle Setting	Fabric Material	Wash Time
Less than 1.6 kg	Low	Gentle	Synthetic, Woolen	5 mins
		Normal	Cotton Hand Spun	10 mins
1.6 -3.5 kg	Medium	Normal	Spoiled cotton, Hand Spun, School Uniforms, Synthetic Clothes	10 mins
3.6 kg-6.5 kg	High	Normal	Cotton, Linen	10-15 mins
			Soiled cotton, Bed sheets, Pillow covers, Towels,	15-35 mins

CAUTION

- Never put organic chemicals like benzene, alcohol or thinner, or even clothes stained with such material in the washing machine as this may lead to fire hazards.
- Never put your hands in the Spin Tub while it is moving.
- The washing machine should be plugged into a separate power socket. Do not take power supply for other appliances from the same source.
- Do not get the control panel wet as this may lead to an electric shock.
- Remove hooks, pins etc. and pull up all zips. If the hooks cannot be removed then tie all of them up in one garment.
- If the Spin Lid is open and the rotations do not stop completely within 15 seconds, it indicates that the self acting brakes are malfunctioning. Get them repaired immediately by an authorised service personnel.
- Switch off the power supply immediately if the supply voltage drops abnormally. Low voltage power supply may result in overheating of the electrical parts of your machine.
- It is necessary to use the Spin Cap for the spinning operation. The cap holds the clothes in place during spinning and prevents them from flying off.
- Do not rub the control panel with chemicals like benzene, thinner, etc. This may deform the parts or the colour may fade.
- Do not keep lit match sticks, Cigarettes or candles near the machine as the plastic parts in your machine may deform or catch fire.
- Do not pour water of temperatures above 50°C into the Wash or Spin Tub as this may result in deformation or damage to the plastic parts.

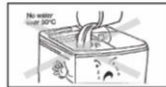
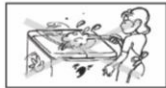

HOW TO MAINTAIN

Before you start cleaning your washing machine, take the electrical plug out of the main power supply socket.

How to clean the wash tub

- If the Wash Tub becomes dirty, clean it with a mild soap and soft brush. Do not use a scourer or a hard brush as this could scratch the Wash Tub.



How to clean the Magic Filter

- Magic filter helps in removing the unwanted lint from the washing tub & collects it, so it not get stuck on the cleaned clothes. You can easy clean this magic filter.
- Place your finger on top of the magic filter, press it and pull it towards you.
- Clean under flowing water.
- To re-insert the magic filter, place the bottom part into the groove of the overflow strainer and push the upper part in place till you hear a click.

WARRANTY

Warranty Conditions :

- 1) Warranty is confined to the first purchase of the McCoy product only & is non-transferable.
- 2) Proof of purchase (i.e. Purchase invoice or purchase receipt) along with corresponding model and/or the serial number of the unit must be presented when requesting service under warranty.
- 3) Repairs under warranty shall be carried out by an authorized service personnel only.
- 4) In case of repairs or replacement of any parts of the unit, this warranty will thereafter continue and remain in force only for the unexpired period of the warranty. Replacement of parts would be purely at the discretion of McCoy alone. In case the replacement of the entire unit is being made, (subject to the sole discretion of McCoy), the same model shall be replaced and in the event such model has been discontinued, it shall be replaced with the model equivalent as deemed by McCoy.
- 5) For units installed beyond municipal limits of the jurisdiction of company's Authorized Service Center, on-site warranty is not applicable and it is the responsibility of the customer to contact the nearest authorized service center and bring the unit to the authorized service center at its own cost and risk. All expenses incurred in collecting the units or parts there of from the company's authorized service center, as well as expenses incurred in deputizing of service personnel/technicians towards conveyance and other incidentals etc. will be borne by the customer. Local Charges for transportation and handling charges may vary from location to location. Customers are advised to verify before.
- 6) The company or its Authorized Service Center reserves the right to retain any parts or component replaced at its discretion, in the event of a defect being noticed in the equipment during warranty period. Where a warranty is provided the product or part replaced becomes the property of McCoy.
- 7) It is the sole responsibility of the customer to provide necessary support to the company if the unit to be installed is not suitable for the installer or the service engineer to reach.
- 8) This warranty will automatically terminate on the expiry of the warranty period as specified in the warranty table, even if McCoy product or part may not be in use for any time during the warranty period for any reason.
- 9) In case of any unpredicted situation and spares not being available, McCoy's prevailing depreciation policy (subject to the sole discretion of McCoy & could be change without prior notice) will be applied on the product as a solution.
- 10) No Dealer/Distributor/Retailer has authority to vary the terms of above warranty.

Warranty Limitations :

- 1) Damage or Failure caused by unauthorized modification or alteration or if it is used for other than the intended purpose or caused by improper or reckless use, which shall be determined by the company personnel.
- 2) The unit shall be operated at input voltage and frequency as per the user manual. Any failure due to voltage / fluctuation beyond specified tolerance will not be covered under warranty.
- 3) Consequential or resulting liability, damage or loss to property or life arising directly or indirectly out of any defect in the McCoy product. The company's obligation under this warranty shall be limited to repair of defective parts only under the warranty period.
- 4) Warranty does not cover repair of any external accessories supplied by Dealer/McCoy as promotional scheme irrespective whether the same is manufactured by McCoy or some other manufacturer, installation & configuration of drivers, network & hardware optimizations, cabling or connection.
- 5) Damage caused by transportation and handling, including scratches, dents, chips, and/or other damage to the finish of your product, unless such damage results from defect in materials or workmanship and is reported within fifteen (15) days of purchase (Call 1800 22 0276).

- 6) On removal, tampering or alteration of any identification labels on the machine or any of its components including serial number
- 7) If the product has not been installed, operated, maintained or used in accordance with the instructions and / or specifications given in the Operating Instruction Booklet provided with the product.
- 8) The warranty card is not completed properly at the time of purchase.
- 9) Damage or missing items to any display, open box, discounted or refurbished product.
- 10) Warranty doesn't cover any compatibility and connectivity issue.
- 11) Goods(products) that are not distributed within the region of McCoy India.

Additional Warranty Conditions:

- 1) 2 years warranty is applicable on all parts except Lint filter, knobs, inlet/outlet hose & Top covers.
- 2) Special Warranty or Extended Warranties for certain parts of products (DD Motor, Main Motor) does not include labor, only parts.

Warranty Summary	: 2 Years Comprehensive and 5 Years on Motor from McCoy
Covered in Warranty	: All Parts Excluding Outer Cabinet and Plastic Parts from the Date of Purchase will be Covered Under Warranty. This also Covers all Manufacturing Defects
Not Covered in Warranty	: Parts: Outer Cabinet and Plastic Parts. Any Accessories External to the Product. The Product is Not Used according to the Instructions Given in the Instructions Manual. Defects Caused By Improper Use as Determined By the Company Personnel. Modification or Alteration of any Nature Made in the Electrical Circuitry/or Physical Construction of the Set. Site (Where the Premises is Kept) Conditions that Do not Confirm to the Recommended Operating Conditions of the Machine. The Serial Number is Removed, Altered or Obliterated from the Machine. Defects Due to Cause Beyond Control Like Lightning, Abnormal Voltage, Acts of God or While in Transit to the Service Centers or Purchaser's Residence.
Warranty Service Type	: Technician Visit

Force majeure: the company is not to be held liable in any manner for the services of the said product on account of strikes, lock-outs, major labour problems, non-availability of essential raw materials, government regulations, civil commotion, riots and acts of God.

Jurisdiction: for all the disputes/differences arising out of these presents, the courts of Mumbai alone shall have jurisdiction.



Bill No. _____

Date _____

Name of the Purchaser _____

Address _____

Phone No. _____

Name & Address of the Dealer with Stamp

Signature of Dealer

Customer Care: 022 28530234/35/36/37

Email: customercare@mccoyindia.in

Whatsapp Helpline: 8291270276

 Toll Free No.: 1800 22 0276

This warranty is not valid if above information is not duly filled in.

Paste QR Code Here



Marketed by:

CANBARA INDUSTRIES PVT. LTD.

SSAS Complex, Lekhraj Devraj Industrial Estate,
Kherani Road, Sakinaka, Andheri (E),
Mumbai - 400 072, INDIA.

Follow us @ McCoy Appliances

